

# DATA SHEET

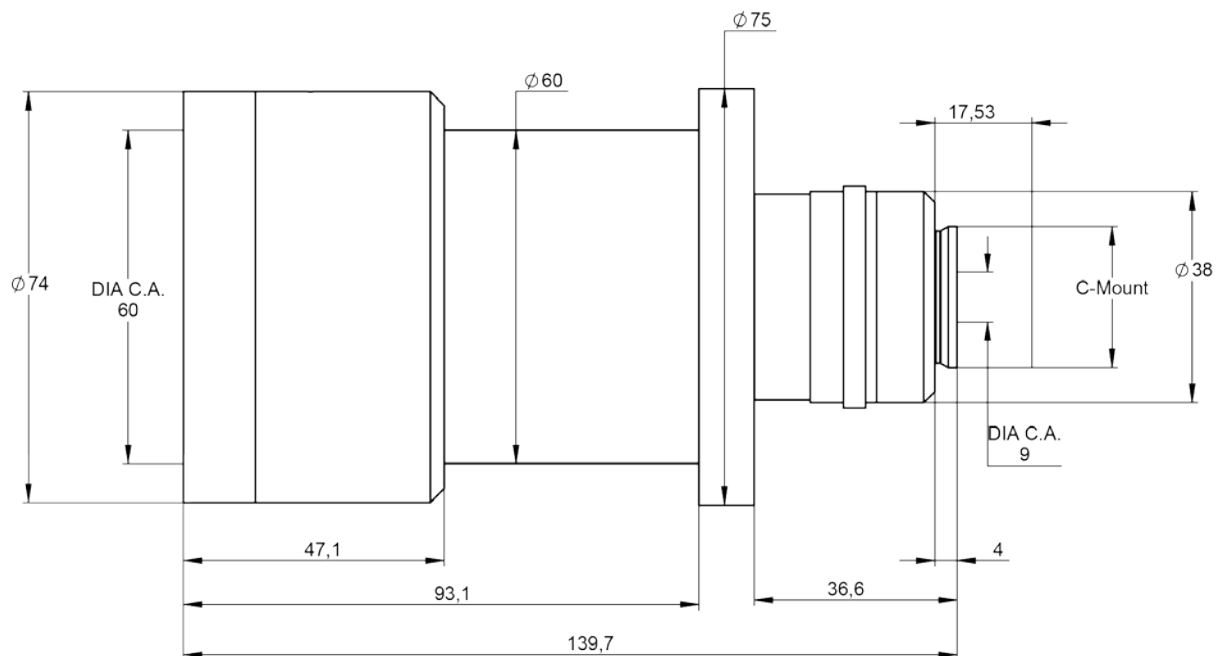

## S5LPJ2298 Correctal® T60/0.24

- telecentric lens
- with c-mount
- with variable iris



outline drawing

# DATA SHEET



## specifications

article number	S5LPJ2298
design wavelength [nm]	450-700
magnification (+/-5%)	0.244
working distance [mm] (+/-2%)	92.0
object size [mm]	19.6 x 14.7
at a chip size of [mm]	4.8 x 3.6 (1/3")
distortion [%]	< 0.05
object size [mm]	26.2 x 19.6
at a chip size of [mm]	6.4 x 4.8 (1/2")
distortion [%]	< 0.05
object size [mm]	36 x 27
at a chip size of [mm]	8.8 x 6.6 (2/3")
distortion [%]	< 0.05
max. telecentricity error [°]	0.12
numerical aperture	0.02
weight [kg]	0.80
flange back distance [mm]	17.53
accessory	S5SET0020, S5SET5016

## Distortion for 586 nm

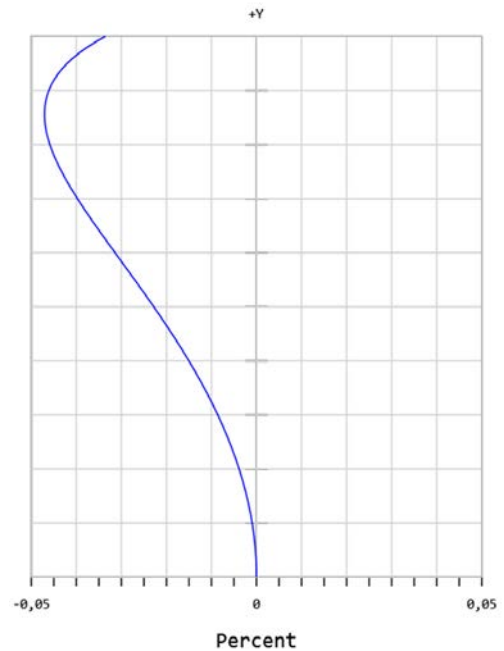

x = distortion

y = max. field

## MTF for various object heights at 586 nm

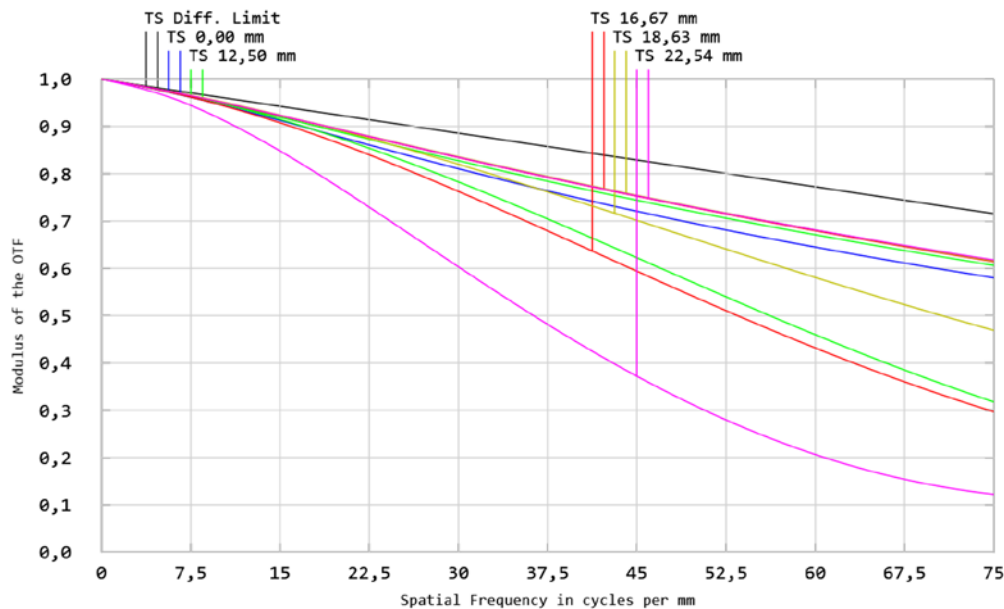

T. tangential

S. sagittal

graphs and data given by design.